

- Equipped with a lens system for high quality accent lighting in museums and exhibition spaces
- Combination of LED PCBs, lenses and optic structure provide uniform light distribution with high intensity and soft transitions, without stray light from the light cone
- Lens can be easily exchanged for other light distribution characteristics from super spot to wide flood
- Elegant slim design, front ring for glare reduction and with air cooling design
- Spotlight head rotates through 350°, pivots through 90°
- Luminaire luminous flux up to 100lm/W
- Lamp unit of diecast aluminum, coated black or white



Colour temperature: 3000 K (930: warm white),
4000 K (940: intermediate) or 5700K (957: cool white)

Colour Rendering Index: Ra > 90

Colour tolerance: SDCM 3 initial

Service life: 30000 h at 90 % luminous flux or 70 % luminous flux, 3 years warranty

Technical data

Wattage	20W
Voltage	AC176-264V
LED Lumen(lm)	3600±10%
Luminaries Lumen(lm)	2000±10%
CCT(K)	3000K/4000K/5700K
CRI	Ra90
Dimming control	Non-dimmable
Beam Angle(°)	15°/24°/36°/45°/60°
Ingress protection:	IP20
Single package dimensions	(LxWxH):78x85x262mm
Outer package dimensions	(LxWxH):435x332x272mm
Qty:	20PCS

- Power off before replacement
- Do not in violation of any fire regulations when using
- Consult competent electricians for technical support
- If the supply cord is damaged, it shall be exclusively replaced by the manufacture or his service agent or similar qualified person in order to avoid a hazard

Technical Drawings

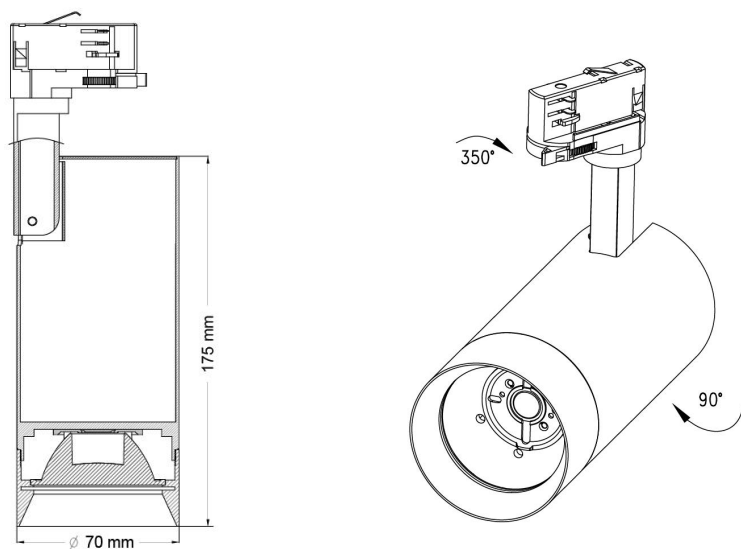

Standard Track

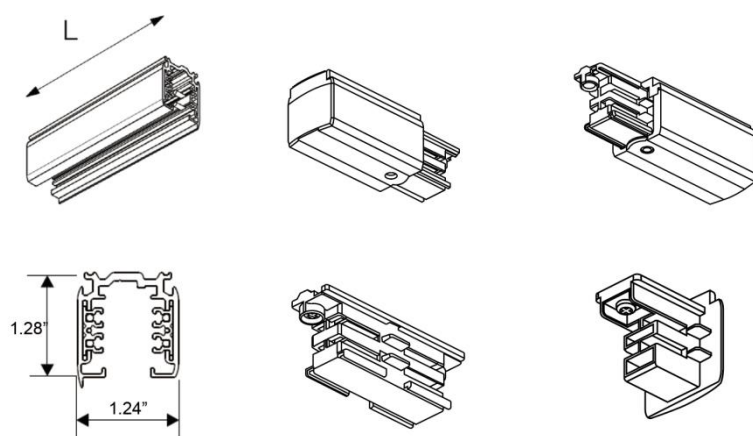

Photometric Information

